

# **User Manual Book**

## **Vacuum Cleaner**

**Quillo Series**

VC 3213

**Gevole Series**

VC 1505



Thank you for your trust in choosing MODENA products for your household needs. With your satisfaction as our priority, we constantly aim to deliver stylishly designed products equipped with state-of-the-art technology to assist you in your daily activities.

This is your guidebook containing everything you need to know about our product. Please reach out to us if you need further assistance or other information via our Customer Care or our official website [www.modena.com](http://www.modena.com).

# MODENA

<b>CONTENTS</b>	<b>PAGE.</b>
• Introduction	1
• Part 1 : Name of Parts	3
• Part 2 : Installation	4
• Part 3 : How to Use	7
• Part 4 : Maintenance	9
• Part 5 : Precaution Action	9
• Part 6 : Problem & Solution	11
• Part 7 : Specification	12

## Part 1: Name of Parts

VC 3213 N, Y, U

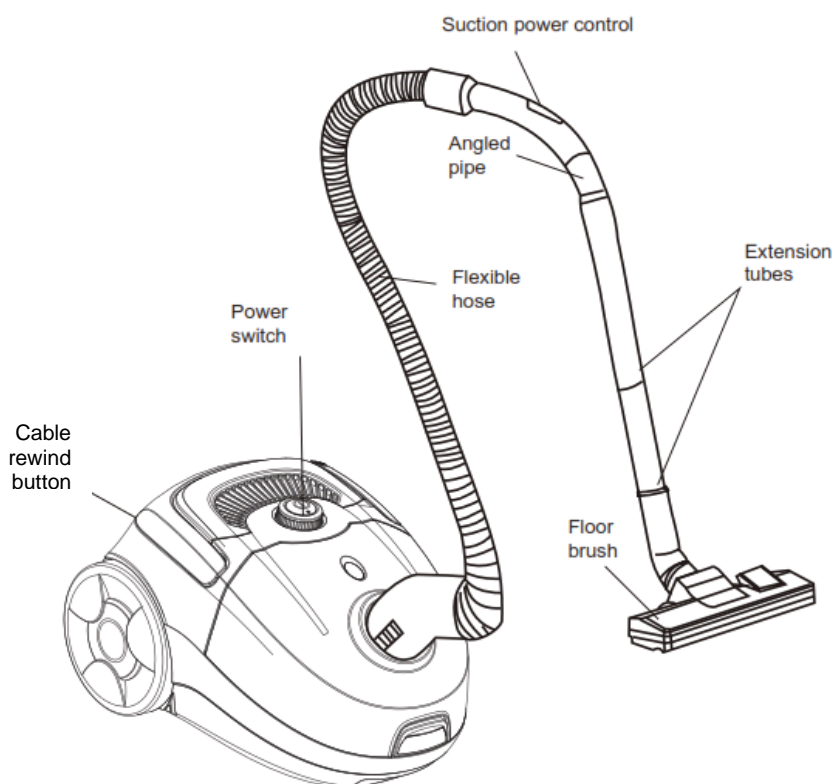

VC 1505

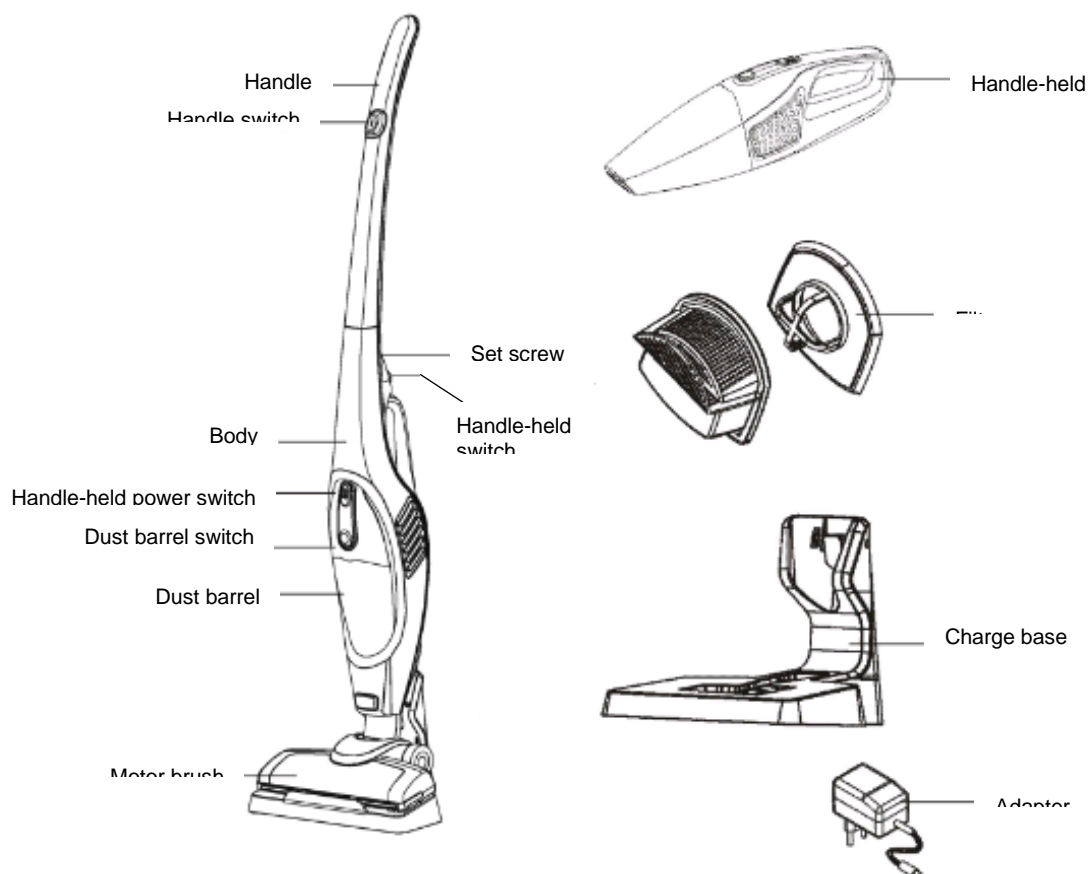

### 1. Floor /Carpet



- Extend / deploy the brush to clean the hard floor surface.

### 2. Gap



- Pull /retract the brush to clean the carpet.

### 3. Small brush



- Used for radiator, gap, corner and gap between the sofa cushions.



- Used to clean the curtain, books, shelf, lamp shade and other similar objects.

\* Features depend on the type of product.

## Part 2: Installation

### Important:

1. Read this manual thoroughly before starting operations.
2. Check whether the voltage specified on the unit fits with the one in your house. If not, contact the MODENA Call Center for further inquiries.
3. Unit must be connected with a properly grounded 10A electrical outlet.
4. Always unplug the power cord before installing/detaching accessories, disassembling the unit, when the unit is not to be used for a long time, or before cleaning and repairing.
5. Do not use solvent substances (methyated spirits) to clean the unit
6. Do not use the unit on wet surface.
7. When the unit is activated, do not leave it without supervision. Make sure to keep it away from children or incompetent people.
8. The unit is meant for house hold usage. Use it according to the instructions provided in the manual.
9. Do not activate the unit if the unit is damaged.
10. Contact the dealer or call center for repairs and aftersales service.
11. If the power cord is damaged, contact MODENA call center for replacement.
12. This unit is not meant to be used by children, mentally or physically challenged, or those who lack the experience and knowledge regarding the unit. For safety precautions, provide serious instructions and guidance when they attempt to do operations.
13. Keep the unit away from children's reach.
14. If you wish to unplug the power cord from the socket, pull the plug, not the cord. If the power cord is damaged, both cord and the plug must be repaired by a qualified technician.
15. If the dust indicator lights turns red, immediately replace or clean the dust container.
16. Replace or clean the dust container on a regular basis to prolong the product's age.
17. Make sure the front cover is always attached.

## CONNECTING THE VACUUM CLEANER

### Remove flexible pipe

Remove the cord plug from the socket before releasing the flexible pipe from the air inlet.

### VC 3213 N, Y, U

Press the flexible pipe until it clicks into the locking position.  
Press and pull the flexible pipe to release.



### VC 1505

#### Main unit assembling

Connect the handle and the body  
Screwed with the set screw

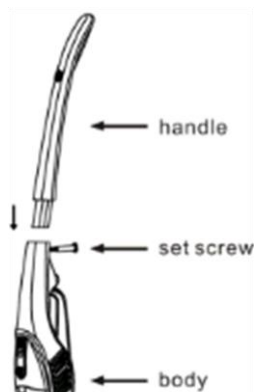

#### Motor brush assembling

Fit the motor brush with the body until it clicks into the position.

Remove the motor brush

Press the knob and remove the brush from the body.



#### Charge base assembling

Fit the back into the charge base

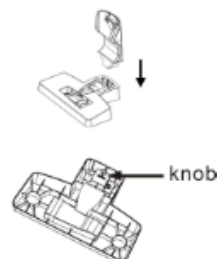

### Installing and connecting additional pipes and accessories

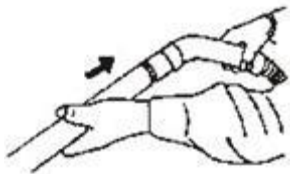

- Install additional pipes on the handle.

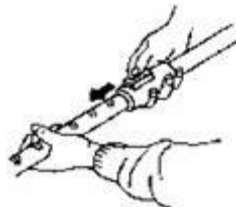

- Connect additional pipes.

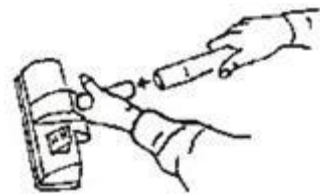

- Install accessories to the additional pipe.

### Emptying and replacing dust bag

After removing the flexible pipe, open the cover by pressing the lock button and pull it upwards. Then, remove the dust bag.

#### VC 3213 N, Y, U

1. Open the front cover by pressing the button and pulling it upwards.
2. Clean the dust bag and reinstall it to the unit.

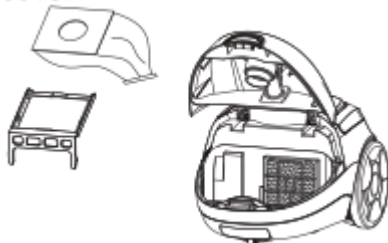

### Replacing filter and outlet filter

1. Open the front cover by pressing the button and pulling it upwards.
2. Remove the motor filter and the outlet filter. Then, replace with the new filter and reinstall it to the unit.



### Filter replacement and cleaning VC 1505

1. Press the hand-held lock, remove the hand-held
2. Press the dust barrel lock, remove the dust barrel, empty the dirt inside
3. Remove the filter, clean the filter with water, wait for it to dry completely
4. Put the filter and dust barrel back into the hand-held



Figure 1

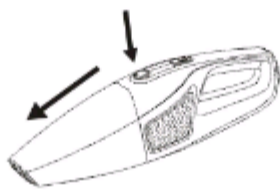

Figure 2

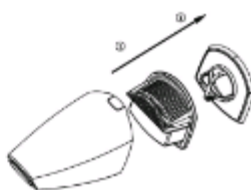
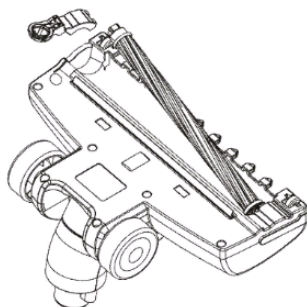

Figure 3

### Cleaning the rotating brush VC 1505

1. Unscrew the bottom brush screw to unlock it (look at the picture)
2. Remove the brush from its place and clean it through.



#### a. Type of dust bag

1. Cloth

To remove the dust from the cloth dust bag, remove the pins on the bottom of the bag to release the dirt inside the bag, clean the bag and pin the bottom part again.

2. Paper

If you use a dust bag made from paper, throw away the bag after usage.

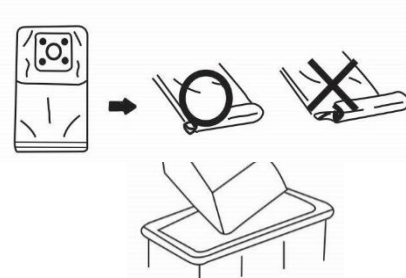

## Part 3: How to Use

1. Before usage, pull / detangle the power cord as necessary and connect the plug to the socket. Red mark represents the maximum efficient length of the cord. Do not pull cord beyond the red mark. To roll the power cord, press the cord roller button with one hand and detangle the cord with one other hand.
2. Press the On/Off button to activate / turn on the unit. Set the vacuum power to MIN before activating the unit.

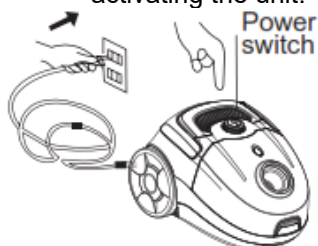



3. Nozzle brush usage.

- Floor/Carpet

Extend / release the brush to clean the hard floor surface.



Retract / pull the brush to clean the carpet.

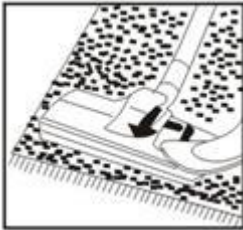

- Small brush

Used to clean the dust on the curtain, book, shelf, lampshade and other objects.

- Gap

Used to clean the gap, corner, radiator and the gap between the sofas.

4. After usage, turn off the vacuum cleaner by pressing the ON/OFF and reroll the power cord.

5. For certain models, do not move the vacuum cleaner when the cleaning pipe is not hooked perpendicularly to the hole / hook on the unit because the floor may be scratched from the brush nozzle.

**VC 1505**

1. Make sure that the battery is fully charged before using the unit. For first time usage, ensure that the machine has been charged for 8 hours

2. Turn off the switch and put the body into the charger base. Then, plug in the adapter into socket.

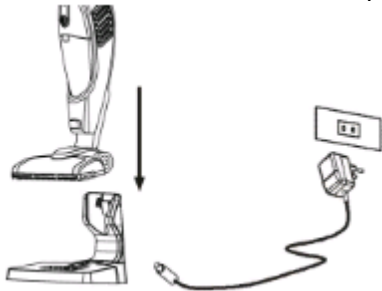

3. Host use: toggle the vacuum cleaner handle switch.

- Brush: Apply to the floor, ground dust or carpet.

4. Handle-held use : toggle the vacuum cleaner mobile switch

- Handle-held: Apply to the bed, sofa, curtains and other parts of the dust.

5. About 15 minutes or when the suction significantly weakened, be sure to shut down for a timely charger.

## Part 4: Maintenance

**Always remove the plug from the socket before performing maintenance on the vacuum cleaner.**

1. Clean the unit using dry cloth. Do not use shining powder, detergent, gasoline, acid, thinner, oil or hot water to clean any part of the unit.
2. Remove the inlet and outlet air filter, clean the filter by submerging it in warm water, and dry the filters inside out. After it's dried, reinstall it back to the vacuum.

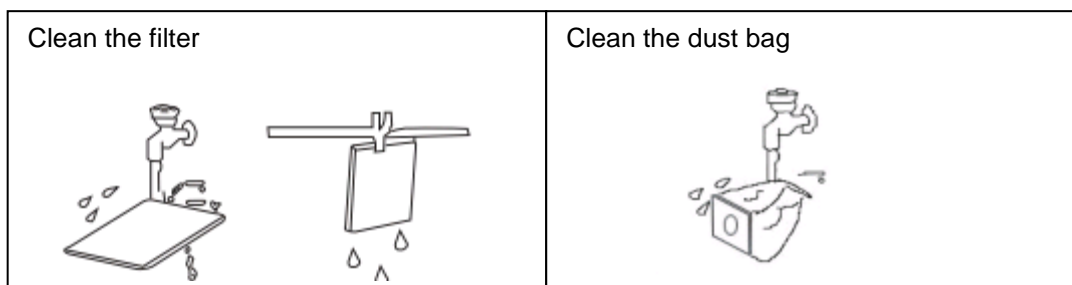

- Make sure the filter is dry when being reinstalled to the vacuum cleaner.
- Make sure it is placed in its proper place.

If the unit is not going to be used for a long time, store it in a dry place with good circulation. Keep it away from children.

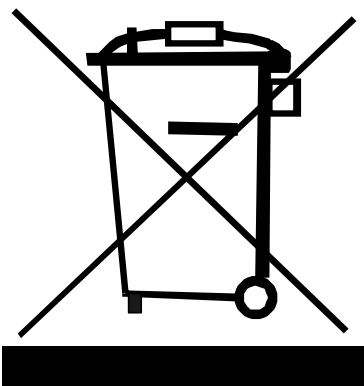

### DISPOSAL Environmental Preservation

Electronic waste should not be disposed of with household waste. Hand over the property to an electronic dump site. Ask for advice from the retailer or the local authorities on how to perform proper disposal and recycle.

### Batteries

Batteries waste should not be disposed of with household waste. Hand over the property to a batteries dump site. Ask for advice from the retailer or the local authorities on how to perform proper disposal and recycle.

## Part 5: Precaution Action

**Perform the following preventive measures before operating the vacuum cleaner:**

- Read all instructions thoroughly and pay attention to the pictures before operating the vacuum cleaners.
- Check the voltage specifications on the vacuum cleaner whether it matches with the voltage in your house. If it doesn't match, contact the MODENA Call Center for further information.
- Do not leave the vacuum cleaner while it is still connected to the socket. Always unplug the power cord from the socket if the vacuum cleaner is not used.
- To avoid electric shock, do not use the vacuum cleaner outside the house or out in the open area and do not put or submerge the power cord or plug in the water or liquid substance.
- Tight supervision is required if vacuum cleaner is used around the children.
- Do not operate the vacuum cleaner if the power cord or the plug is damaged, dysfunctional, taking fall damage, or broken. Take it to our Call Center for inspection & testing, rearrangement of electrical or mechanical functions, and necessary repairs.
- Usage of additional equipment/tools without recommendations and not supplied by the manufacture may result in fire, electric shock / shortage and damage to the vacuum cleaner.

- Special attention is required for usage on stairs.
- If the air inlet, pipe nozzle or telescopic pipe is obstructed, immediately deactivate the vacuum cleaner and clear the obstruction before restarting it.
- Make sure you plug the power cord to the socket with dry hands.
- Remove large or sharp objects on the floor before using the vacuum cleaner to avoid damages to the filter.
- If you wish to unplug the power cord from the socket, pull the plug, not the cord. The damaged cord and plug must be repaired by a qualified technician.

Do not operate the vacuum cleaner near heat sources such as stove, cigarette buds, etc.



Do not use the unit on top of the power cord. Make sure the power cord is not pinned or stepped on when the unit is operating.

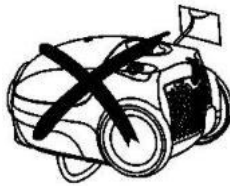

Do not use the unit to vacuum / clean lighted match, lighted cigarette or hot dust.



Do not use the unit on wet surface.



Do not obstruct the air inlet or the drainage.

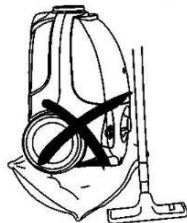

Do not use the unit to vacuum / clean threads, sharp objects, nails, pins, etc.



## ***Part 6: Problem & Solution***

In the event of operational issues, check the following problems and solutions below before contacting our Call Center:

<b>Problem</b>	<b>Cause</b>	<b>Solution</b>
Weak Suction Power	<ul style="list-style-type: none"><li>- Dust bag and the cylindrical filter are obstructed.</li><li>- Brush or nozzle are obstructed.</li><li>- Flexible pipe is obstructed.</li></ul>	<ul style="list-style-type: none"><li>- Replace or clean the dust bag and the cylindrical filter.</li><li>- Clean the brush and nozzle from dust.</li><li>- Clean the flexible pipe</li></ul>
The motor cannot rotate / vacuum	<ul style="list-style-type: none"><li>- Is the cord plugged to the socket?</li><li>- Has the ON button been pressed yet?</li></ul>	<ul style="list-style-type: none"><li>- Reconnect the power cord with the socket.</li><li>- Press the ON Button</li></ul>

## Part 7: Specification

VACUUM CLEANER	VC 3213 N	VC 3213 Y	VC 3213 U
Type	Dry	Dry	Dry
Color	Green	Yellow	Blue
Nozzle material	Fiber	Fiber	Fiber
<b>Main Feature</b>			
Blower function	No	No	No
Cloth filter	Yes	Yes	Yes
Cloth paper	No	No	No
Filter for motor / cylinder	Yes	Yes	Yes
Filter for blower	No	No	No
Overload safety / Motor	Yes	Yes	Yes
Wheel	Yes	Yes	Yes
Suction controller	Yes	Yes	Yes
<b>Accessories</b>			
Nozzles	2	2	2
Flexible hose	1	1	1
Pipe	2	2	2
Exhaust filter	2	2	2
<b>Technical Features</b>			
Capacity (liter)	1.5	1.5	1.5
Cable length (meter)	4.5	4.5	4.5
Noise level (dbA)	75	75	75
Suction power (kPa)	17	17	17
Power Consumption (watt)	350-1200	350-1200	350-1200
<b>Product Dimension</b>			
Depth(mm)	350	350	350
Width(mm)	268	268	268
Height (mm)	218	218	218
Gross Weight (Kg)	4.6	4.6	4.6

VACUUM CLEANER	VC 1505
Type	Dry Handy 2 in 1
Color	Rose Gold
Nozzle material	Fiber
<b>Main Feature</b>	
Blower function	No
Cloth filter	Yes
Cloth paper	No
Filter for motor / cylinder	No
Filter for blower	No
Overload safety / Motor	Yes
Wheel	Yes
Suction controller	Yes
<b>Accessories</b>	
Nozzles	2
Flexible hose	-
Pipe	-
Exhaust filter	1
<b>Technical Features</b>	
Capacity (liter)	0.5
Cable length (meter)	-
Noise level (dbA)	71
Suction power (kPa)	7
Battery Charger (watt)	12
<b>Product Dimension</b>	
Depth(mm)	286
Width(mm)	200
Height (mm)	1135
Gross Weight (Kg)	3.1

S = Stainless W = White V = Silver G = Grey L = Black Y = Yellow U = Blue N = Green  
Design and specifications are subject to change at any time without prior notice.

