

User Manual Book Washing Machine

WF 1030 VDWH

TABLE OF CONTENT

Part 1: Safety Information	3
Precautions	3
Environmental Notice	5
Part 2: Name of Parts	5
Part 3: Installation Guide	6
Installation	6
Part 4: How to Use	12
Door Lock & Unlock	12
Detergent Drawer	13
Precautions Before Washing	14
Control Panel	15
How to Start Washing	16
Washing Programs	16
Part 5: Maintenance	18
Cleaning & Maintenance	18
Drum Self-Cleaning	19
Cleaning the Universal Coupling	19
Cleaning the Inlet Valve	20
Cleaning the Drain Filter	20
Part 6: Troubleshooting	21
Part 7: Specification	23

This guide book explains everything you need to know about your new product. Please contact our Customer Care should you need further assistance through www.modena.com.

PART 1: SAFETY INFORMATION

Read the user manual book carefully!

- Do not try to install or turn on the unit without having read the indicated safety precautions in this manual.
- Do not disassemble the electrical parts of this appliance. Any repairs done by an unauthorized person may cause serious injuries or properties incident.
- The adult should supervise the children in order to make sure the children can not play with the appliance.
- The appliance is not intended for use by persons(including children) with reduced physical, sensory or mental capabilities, or lack of experience and knowledge, unless they have been given supervision or instruction concerning use of the appliance by a person responsible for their safety.
- This appliance is intended to be household use only. Usage outside the intended use or excessive use may void the warranty.
- Do not modify the power cord. If the power cord is damaged, it must be replaced by technician with a replacement cable according to the appliance specification
- To avoid danger of suffocation, keep plastic bag away from babies and children.

Precautions

- Destroy the carton, plastic bag and other packing materials after the appliance is unpacked. Children might use them for play.
- Children require supervision when using the appliance
- Plug the appliance directly into the socket and ensure secure connection
- The unit requires proper grounding and the correct voltage
- An appropriate length of power cord is provided to reduce the risks of becoming entangled in, or tripping over a longer cord.
- Do not use an extension cord or plug adaptor. Failure may cause electric shock or risk of fire
- Choose a place that is near a grounded electrical socket.
- Do not place the appliance sitting over the power cord.

- Do not pull out or insert the plug with wet hands to avoid electric shock.
- Do not fasten, twist or tie the power cord. If the power cord is damaged, it should be replaced by the manufacturer, service technician or a qualified person to prevent any risk.
- Do not spill water directly onto the control panel
- Fix the drain pipe before use, make sure that the drain hole is not blocked
- Keep the unit in a dry place and away from direct sunlight. Do not place the machine on paper or foam. Do not place anything flammable beside this machine.
- When washing at high temperature, the door glass will get hot. Please do not touch the door glass, especially children.
- When the door needs to be opened in high temperature washing, please wait until the temperature drops to the safe temperature and the door lock is automatically unlocked.
- Please close the door when the washing machine is not in use to prevent children from entering the washing barrel.
- Please do not wash waterproof clothes, such as raincoats, down products, sleeping bags, etc.
- Only machine washable clothes can be washed. If in doubt, please follow the washing guide on the clothes.
- Do not wash or dehydrate the clothes stained with kerosene, gasoline, diluent and other flammable materials.
- When the power plug is pulled out, the door lock can be opened even if the water level in the barrel is high. Therefore, in any case, please confirm the water level in the barrel before opening the door. If the water level is high, please do not open the door to avoid unnecessary loss caused by water overflow
- Unplug the unit when the unit will not be used for a long period for the reason of saving electricity.
- Never use organic liquids polishing chemical to clean the machine.

Environmental Notice



The packaging material used is recyclable. We recommend that you separate plastic, paper and cardboard and give them to recycling agents. According to WEEE (Waste of Electrical and Electronic Equipment) guidelines, waste from electrical and electronic devices should be collected separately. If you need to remove of this appliance in the future, do not throw it away with the rest of your domestic garbage. Instead, please take the appliance to the nearest WEEE collecting agents, where available.

PART 2: NAME OF PARTS

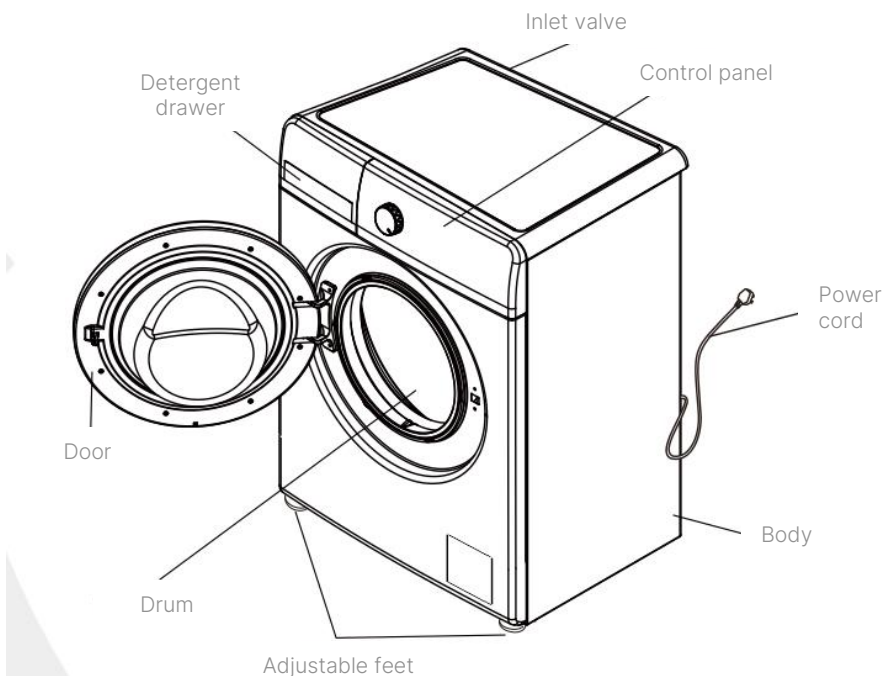

Above picture is for reference only. Actual product may have slight difference

PART 3: INSTALLATION GUIDE

Installation

- The appliance should not be installed in an environment below 0°C. Do not install or place the washing machine outdoors.
- When the washing machine is installed on a floor with a carpet, do not block the ventilation orifice of the base.
- If there are many insects in the installation environment, please keep the surroundings of the washing machine clean. The warranty does not cover any damage caused by cockroaches or other insects.

Shipping/Transportation Bolts

The appliance is equipped with shipping bolts that are used to prevent internal damage of the washing machine during transport. To disassemble the shipping bolts, follow these instructions:

1. Open the package, remove the packaging base and move the washing machine to the installation place.
2. Disassemble the 4 shipping bolts, rubber pads and plastic rods (see Figure 1). If the shipping bolts are not disassembled, they may cause intense vibrations, noise and faults. The shipping bolts shall be installed every time before the washing machine is transported.
3. Use the supplied plastic plugs to cover the four holes. (see Figure 2).

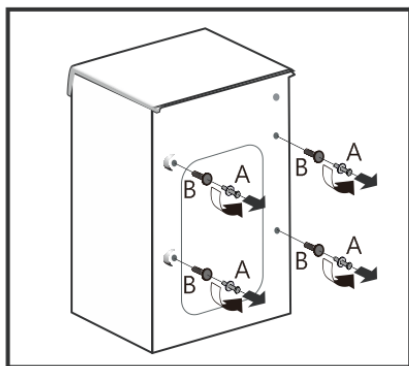

Figure 1

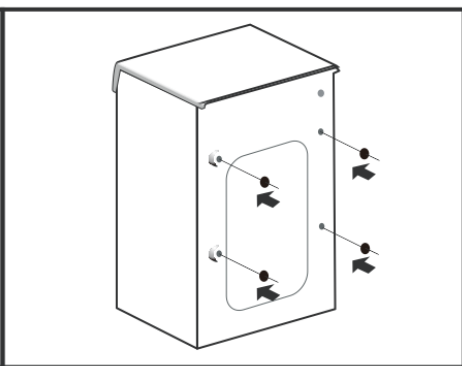
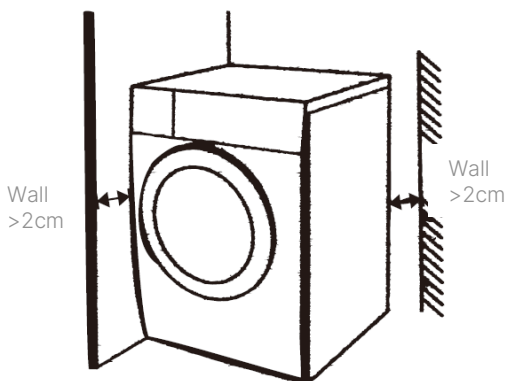

Figure 2

- The tilt angle shall not exceed 1 degree.
- Allow sufficient safety distance between the washing machine and the wall or other objects. Distance between the back/left/right of the washing machine and the wall/object should be more than 2 cm.



- Install the washing machine on a hard and flat floor with a drain hole. Do not install on soft carpeted or wooden floors.
- Do not put clothes to be washed or other objects at the worktop of the washing machine because they will affect the running of programs.



Connecting the power supply

- The washing machine must have a grounding device. The grounding device can reduce the danger of electric shocks in case of a failure. This device has a grounding line (a conductor with a grounding plug). The grounding plug must be inserted into an appropriate power outlet.

- Please contact professional persons to test whether or not the washing machine is grounded correctly. If the power outlet and the power plug do not match, please do not change the power plug.
- If the washing machine smokes or emits a peculiar smell, please cut off the power supply and contact service center.

ATTENTION!

To ensure quality, the washing machine is filled with water for testing at the factory, water may remain in the interior of the drum, the door seal and the door glass, and this is a normal condition.

Connecting the water supply hose

- The water supply pressure must be from 0.05-0.85 MPa.
- During connection of the water supply hose and the inlet valve, do not screw them tightly to avoid slipping.
- There are 2 seal rings in connectors at both ends of the water supply hose to prevent water from leaking.
- Turn on the faucet to check the connectors for any water leakage.
- Check the water supply hose regularly and replace it if necessary.
- Make sure that the water supply hose is not warped or damaged.

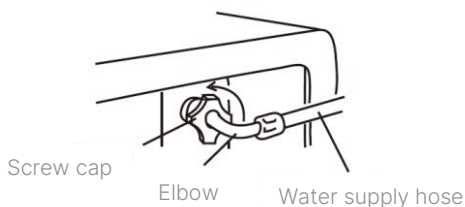

ATTENTION!

Use the new hose assembly that comes with the washing machine. The old hose assembly cannot be reused.

Connection of water supply hose to faucet

1. Hold the connector with one hand, press the retaining ring with the other hand and pull it down to separate the connector from the water supply hose.

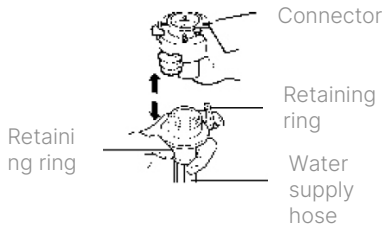

2. Loosen the four mounting screws on the upper part of the connector, and rotate the lower part of the connector to leave a distance enough (equal to the height of 3 threads) for installing screws between the upper part and the lower part of the connector.

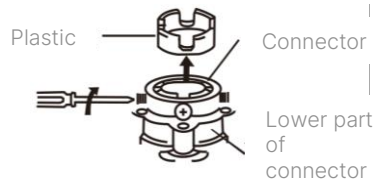

3. Adjust the four screws of the connector evenly so that two screws near the wall are fully in contact with the exterior of the faucet first.

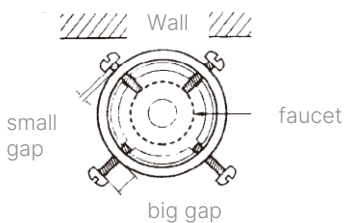

4. Hold the upper part of the connector against the mouth of the faucet so that the seal ring in the connector is fully in contact with the faucet (please do not take out the seal ring).

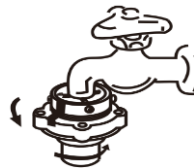

5. Rotate two screws (see figure below) opposite to the wall so that they are in contact with the faucet, and screw them with a screwdriver tightly.

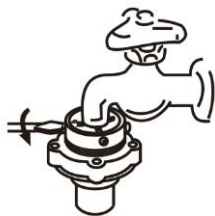

6. Rotate the lower part of the connector to screw it tightly (or else, water may leak from the connection). After rotation, the clearance between the lower part and the upper part of the connector shall be lower than 3mm.

lower
than 3
mm



Connector

7. To remove the water supply hose, please press the retaining ring of the water supply hose.



Retaining ring

8. To install the water supply hose, please turn the retaining ring of the water supply hose back to release it.



Ensure
that the
retaining
ring is
intact

9. Check whether or not the lower part of the connector and the water supply hose are connected firmly.
 - Screw the connector of the water supply hose and the inlet valve tightly. Slowly turn on the faucet to check for water leakage.
 - If water leaks from the connection, please turn off the faucet and assemble them again. (Water may leak from the connection if the upper part of the connector is not assembled correctly or the upper part and the lower part of the connector are not screwed on tightly.)
 - After using for a long time, the connection may be loose. Then, please assemble parts again by following steps 1-9. (If it is necessary to assemble the connector of the water supply hose after a move, please follow steps 1-9 too.)

Installing the drain hose

To ensure normal operations of the washing machine, the inner diameter or width of the end of the drain hose to be inserted into the sewer shall be no less than 4cm. The height of the outlet of the drain hose shall be within a certain range. For specific data, please refer to the figure below.

The end of the drain hose cannot be immersed in water

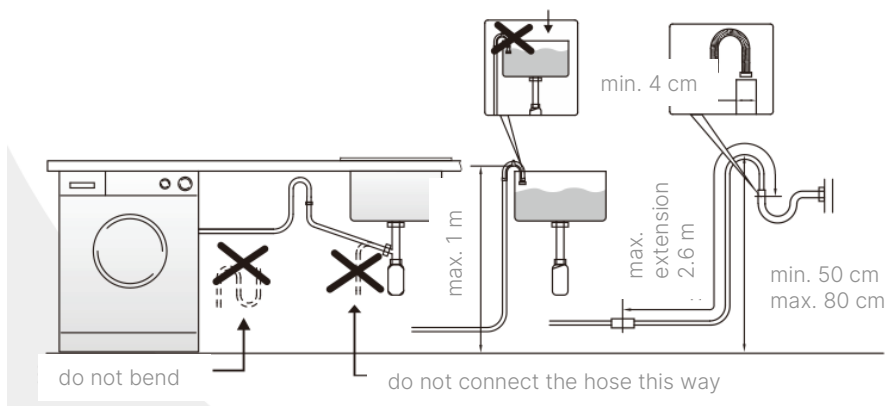

Horizontal adjustment

- Adjust the level of the washing machine to avoid additional noise and vibrations. Install the washing machine on a hard and horizontal floor (the corner of a room is preferred).

- If the floor is not flat, please adjust the adjustable feet. (Do not insert objects such as wood chips under the adjustable feet). Make sure that the four adjustable feet are in contact with the floor firmly and check that the washing machine is horizontal. (use a levelling tool).
- Adjust the adjustable feet so that the washing machine is flat and stable on the floor. After position adjustment, screw the locknuts tightly to keep the washing machine stable.
- Do not place the washing machine on a table on the floor to prevent it from falling accidentally.
- When pressing each corner of the worktop of the washing machine, it should not move. (Check on all corners. If the washing machine still moves, please readjust the adjustable feet)

PART 4: HOW TO USE

Door Lock & Unlock

Door Lock

After wash program startup, the door will be locked automatically and cannot be opened. Then, the “Lock” light/icon on the control panel illuminates.

Door Unlock

- When the “Lock” light/icon on the control panel illuminates, press the “Start/Stop” button. After the washing/spin drum stops rotating, wait for 2 minutes until the door is unlocked automatically.
- Foams may rise from the drum during washing. Please clean it with a towel
- During washing, the door cannot be opened at high temperature.
- During washing, the door cannot be opened with high water level.

Detergent Drawer

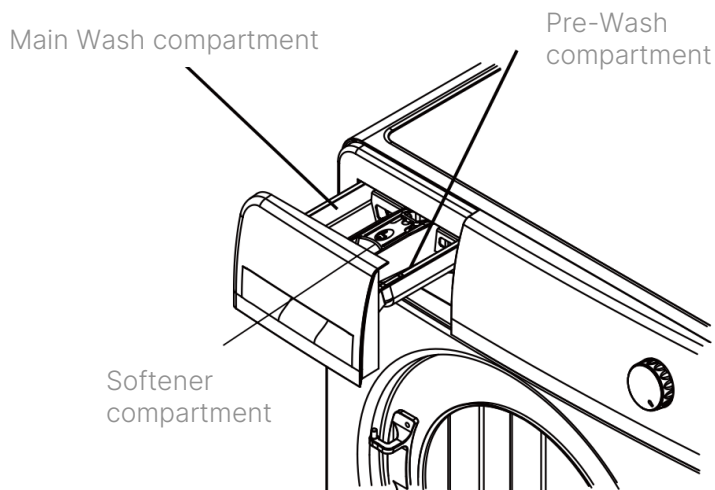

Main Wash Compartment

- Please use synthetic low-foam liquid detergents.
- If concentrated liquid detergents are used, please dilute them with water (2:1) and pour them into the detergent compartment.

Softener Compartment

- Add softeners before washing. The washing machine will automatically inject softeners into the drum during the final rinse.
- If concentrated softeners are used, please dilute them with water appropriately and evenly and pour them into the detergent compartment.
- Do not exceed the "Max" line.

Pre-Wash Compartment

- If the clothes are very dirty, please add appropriate detergents after selecting the pre-wash function. (The quantity of detergents varies with models)

ATTENTION!

- Use detergents made specially for drum washing machines.
- Do not use too much detergent, or too much foams may affect the rinse effect or cause functional faults.
- Please follow the instructions of the manufacturer to use detergents by the kinds and colors of clothes, water temperature, degree of staining, etc.
- Using appropriate detergents has good washing effect and is beneficial for environmental protection.

Precautions Before Washing

- Read the care labels of clothes. The kind, materials and washing method of a cloth are printed on a care label.
- Always sort your laundry to achieve the best result. Wash only one kind of clothes in a washing period. Water temperature, spin speed and programs vary with clothes. Dark clothes shall be washed separately from light and white clothes. Dyed clothes and cotton velvet clothes shall be washed separately, or the white clothes may be stained. If possible, do not wash very dirty clothes with moderately dirty clothes.

Control Panel

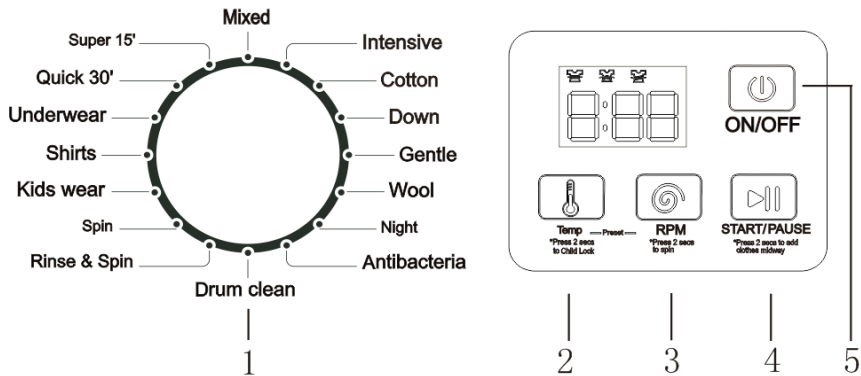

Note: Control panel image is for reference only, actual product may have slight difference

1. Program Selection Knob

Select an appropriate program by kinds of clothes and degree of stains.

2. Water Temperature Button

- Select the water temperature by the kinds of clothes and degree of staining.
- The range of water temperature varies with programs. The water temperature is not required for some programs.
- After the program starts, press for more than 2 seconds to turn toggle the child lock function. After setting the child lock function, except for the "POWER" button, other buttons cannot be used.

3. Dewatering Speed Button

- Press this key to select dewatering speed or spin speed
- Press and hold this button for 2 seconds to start the dewatering or spin function.

4. Start/Pause button

- Press this button to start the selected wash program.
- During operation, press this button to stop a program temporarily and press it again to restart this program.

- Press and hold this button for 2 seconds to open the door temporarily for adding clothes during operation.

5. “Power” button

- Press this button to turn the appliance ON or OFF.
- After a program is finished, press the “Power” button to turn off the appliance

How to Start Washing

1. Prepare for washing
 - Open the door, add clothes to the drum, and close the door
 - Open the detergent drawer, add detergents and fabric softener, and close the detergent drawer
 - Connect the water supply hose, and make sure that the faucet is turned on
2. Press the “Power” button to turn on the appliance
3. Select the appropriate wash program for your laundry
4. Press the “Water Temperature” button to set the water temperature if needed
5. Press the “Start/Pause” button to start the wash program
6. After washing is finished:
 - The LED flashes and the washing machine gives a buzzing sound
 - Open the door to take out the clothes
 - Unplug the power plug and turn off the faucet

Washing Programs

Program	Water temperature (°C)	Rinse	Max load	Cloth type
Mixed	40/normal/20	2	≤4kg	Cotton fabric/chemical fiber fabric
Intensive	40/60/85/normal/20	2	10 kg	Dirty cotton fabric/chemical fiber fabric

Program	Water temperature (°C)	Rinse	Max load	Cloth type
Cotton	40/60/85/normal/20	2	10 kg	General cotton fabric
Down	40/normal/20	2	≤3kg	Down clothing
Gentle	40/normal/20		≤3kg	Wool, silk, synthetics
Wool	40/normal/20	2	≤3kg	Machine washable wool fabric
Night	40/60/normal/20	2	≤4kg	Cotton fabric/chemical fiber fabric
Antibacterial	85	2	≤4kg	Need to eliminate mite, bacteriostatic cotton fabric
Drum Clean	85	2	-	Washing machine cleaning, sterilization
Rinse+Spin	-	1	10 kg	Cotton fabric/chemical fiber fabric
Spin	-	-	10 kg	Cotton fabric/chemical fiber fabric
Kids wear	60/85/normal/20/40	3	≤4kg	Kids wear from cotton/synthetics

Program	Water temperature (°C)	Rinse	Max load	Cloth type
Shirts	40/normal/20	2	≤4kg	Cotton fabric/chemical fiber fabric
Underwear	40/60/normal/20	2	≤3kg	Cotton fabric/chemical fiber fabric
Quick30'	normal/20/40	2	≤2kg	Less soiled clothes or towels that are used frequently
Quick15'	normal/20/40	1	≤2kg	Less soiled clothes or towels that are used frequently

Notes:

1. The first parameter of water temperature and spin speed is the default parameter at startup
2. You can select other parameters manually if available
3. The washing time required may vary with water pressure, drainage conditions, clothes type and water temperature
4. When the washing machine starts up after a power failure, it runs from the time node before the power failure occurs

PART 5: MAINTENANCE

Cleaning & Maintenance

1. Periodic cleaning & maintenance can prolong the life time of your appliance
2. Ensure the power cord is unplugged before performing cleaning and maintenance activity
3. Please wipe the body with a soft and clean cloth every time after the washing machine is used. When there are serious stains, please wipe

the body with a cloth dipped in appropriate detergents or soapy water.

4. Do not spray water on the body directly
5. Do not wipe the body with chemicals such as putty-powder, diluting agents, gasoline and alcohol
6. Clean the Door Seal. Please wipe stains and foreign matters such as thread chips away with a towel every time after using. If there are foreign matters such as pins in the groove of the door seal, please take them out.
7. To prevent detergents becoming moldy on the wall of the detergent drawer, please clean the detergent compartment regularly.
8. Press the specified position and pull out the detergent drawer, wash it with water and put it back.

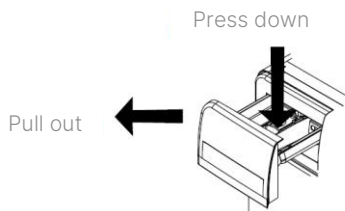

Drum Self-Cleaning

After using for a long time, there may be stains in the washing drum. The drum self-cleaning program can be used to clean the exterior and the interior of the drum. Recommended every month

WARNING!

During drum self-cleaning, do not add clothes or detergents.

Cleaning the Universal Coupling

1. Remove the water supply hose from the universal coupling.
2. Loosen off the fastener from the faucet.
3. Rinse the interior of the fastener with water.

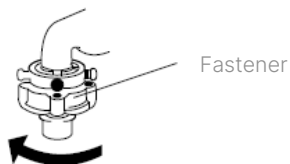

4. Install the clean fastener and the water supply hose.
5. Recommended every 6 months

Cleaning the Inlet Valve

1. Remove the water supply hose from the washing machine.
2. Take out the filter screen from the inlet valve.
3. Clean the filter screen thoroughly with a toothbrush or similar tools.
4. Install it to the inlet valve.
5. Connect the water supply hose again.
6. Recommended every 6 months



Inlet valve

Cleaning the Drain Filter

1. After drainage, disconnect the power plug, press the clip above the decorative cover for the drainage pump at the right corner in the front of the body, and open the filter cover. (Note: if there is hot water in the washing machine, please take the above actions only after cooling.)
2. Screw off the filter counterclockwise.
3. Rinse the filter thoroughly with water.
4. Insert the filter, screw it clockwise and close the decorative cover for the drainage pump.

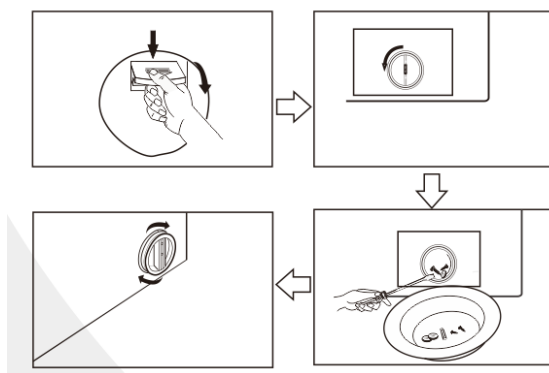

ATTENTION!

The filter must be tightly screwed to prevent water from leaking.
Do not clean the filter when a program is running

PART 6: TROUBLESHOOTING

Before contacting service center, check the following table:

Problem	Possible Cause	Recommended Action
Appliance is not working	<ul style="list-style-type: none">• Power plug is plugged incorrectly• Switch is in OFF condition	<ul style="list-style-type: none">• Ensure the appliance is properly plugged into the power socket and the switch is turned ON.
Poor Spinning and abnormal noise	<ul style="list-style-type: none">• Transportation bolt still attached• Incorrect installation• Overloading/overfilling the drum• Incorrect adjustment of feet	<ul style="list-style-type: none">• Remove the transportation bolt• Install on a hard and level surface• Load the drum according to the recommended capacity• Adjust and lock the adjustable feet
Too much bubble	<ul style="list-style-type: none">• Improper use of detergent	<ul style="list-style-type: none">• Use low foam detergent for washing machine
Door cannot be opened	<ul style="list-style-type: none">• Program is running	<ul style="list-style-type: none">• Wait until the program is finished
Abnormal smell/odor	<ul style="list-style-type: none">• Rubber parts in the appliance	<ul style="list-style-type: none">• Rubber parts may produce smell
E1 – Inlet fault	<ul style="list-style-type: none">• No water supply• Low water pressure• Clogged inlet	<ul style="list-style-type: none">• Check if the water is supplied correctly or faucet is turned on• Check the water pressure• Clean the inlet valve

Problem	Possible Cause	Recommended Action
E2 – Door fault	<ul style="list-style-type: none"> • Door is open when program is started 	<ul style="list-style-type: none"> • Check if the door is opened. Close the door
E3 – Drain fault	<ul style="list-style-type: none"> • Drain pipe too high • Clogged drain outlet 	<ul style="list-style-type: none"> • Install according to recommended height • Clean the drain outlet
E4 – Injecting water fault	<ul style="list-style-type: none"> • Technical failure 	<ul style="list-style-type: none"> • Close the faucet, turn of the appliance, and contact Service Center
E6 – Heating fault	<ul style="list-style-type: none"> • Technical failure 	<ul style="list-style-type: none"> • Close the faucet, turn of the appliance, and contact Service Center

PART 7: SPECIFICATION

Model	WF 1030 VDWH
Color	White
Type	Front Load
Wash Capacity (kg)	10.5
Max. Spin Speed (rpm)	1200
No. of washing programs	16
Inlet water pressure (MPa)	0.05-0.85
Cold Wash power (Watt)	150
Spin power (Watt)	500
Hot Wash power (Watt)	1800
Motor type	Intelligent Inverter
Rated voltage	220-240V~50Hz
Product dimension (W×D×H)(mm)	598×608×845
Product weight (kg)	57

S = Stainless, R = Red, C = Cream, O = Orange, N = Green, U = Blue, W = White, V = Silver, G = Grey, L = Black

Design and specification can change without prior notice to improve the quality of the product. The illustration in this manual is schematic and can be different with your actual product. The values on label or in other documents are according to laboratory test and relevant standards. Values can vary depending on the actual operational and environmental condition of the product.

Ciao! **MODENA**

www.modena.com

PT MODENA INDONESIA

Jl. Industri Raya I Blok D-8,
Jatiuwung, Tangerang 15135